

H6G



- Alloy steel IP66 single point load cell
- Nickel plated
- Suitable for platform, belt and other electronic scales
- Maximum platform size: 600 x 600 mm



Available models

Capacity	Accuracy	Full article description
xxkg	C3	H6G-C3-xxkg-3B6
xxkg	C3	H6G-C3-xxkg-3G6

G:The Insulation resistance between bridge circuit and shielded wire is zero

Specification

Accuracy class		C3
Output sensitivity (= FS)	mV/V	2.0 ± 0.2
Maximum capacity (E _{max})	kg	100, 150, 200, 250, 300, 500, 600
Maximum number of load cell intervals (nLC)		3000
Ratio of minimum LC verification interval $Y = E_{max} / V_{min}$		10000
Combined error	%FS	± 0.020
Safe overload	of E _{max}	150 %
Ultimate overload	of E _{max}	300 %
Zero balance	%FS	± 1.0
Excitation, recommended voltage	V	5 ~ 12 (DC)
Excitation maximum	V	18 (DC)
Input resistance	Ω	384 ± 4
Output resistance	Ω	351 ± 2
Insulation resistance	MΩ	≥ 5000 (50VDC)
Compensated temperature	°C	-10 ~ +40
Operating temperature	°C	-35 ~ +70
Element material		Alloy steel, nickel plated
Ingress protection (according to EN 60529)		IP66
Recommended torque on fixation	N.m	20
ATEX classification (optional)		II1G Ex ia IIC T4 II1D Ex iaD 20 T73°C II3G Ex nL IIC T4

Note: "S1" output sensitivity is 2.0 ± 0.002mV/V, input resistance is 384 ± 4

Dimensions in mm

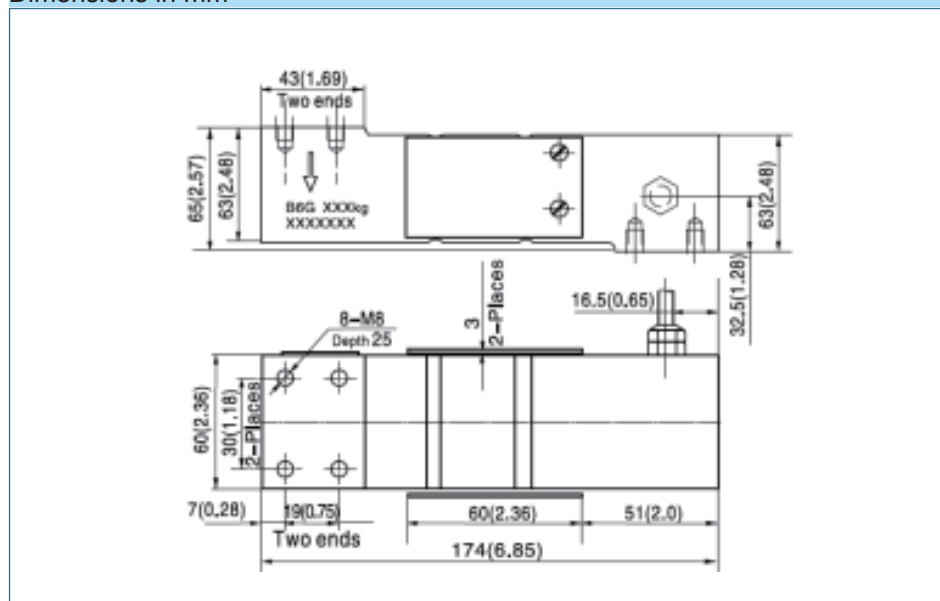

Wiring

- Shielded, 6 conductor cable.
- Standard cable length: 3m.
- Transparent shield.
- Cable type and cable length for customer's own application are available on request.
- Shield not connected to element.